



標準螺絲供應有限公司 (513831-P)
STANDARD BOLTS & NUTS SDN. BHD.

No. 47 & 49, Jalan TPP 1/1, Taman Industri Puchong, 12th Miles,
 47100 Puchong, Selangor Darul Ehsan, Malaysia.

Tel: 03-8062 3811 (Hunting Line)
 Website: <http://www.standardbolts.net>

Fax: 03-8062 2230, 8068 2811
 E-mail: sale@standardbolts.net



DROP IN ANCHOR

Material:

Steel
 Stainless Steel 304 (A2)

Finishing:

Steel comes in Blue Zinc Finishing



Anchor Size	Anchor Length	Thread Length	Fixture Hole Diameter
M6 (1/4")	25MM	11MM	7MM
M8 (5/16")	30MM	14MM	9MM
M10 (3/8")	40MM	17MM	12MM
M12 (1/2")	50MM	20MM	14MM
M16 (5/8")	65MM	25MM	18MM
M20 (3/4")	80MM	30MM	22MM

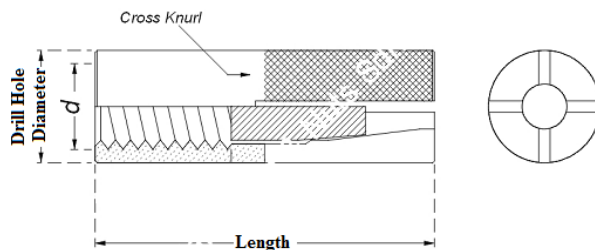

SBN Klang (Branch)

Standard Bolts & Nuts (Klang) Sdn Bhd
 No. 135 & 137, Jalan Batu Tiga Lama,
 Berkeley Town center, 41300 Klang,
 Selangor Darul Ehsan, Malaysia
 Tel: 03-3344 1198 (Hunting Line)
 Fax: 03-3344 2811
 Email: sbnk@standardbolts.net

SBN Sg Buloh (Branch)

Standard Bolts & Nuts (Sg. Buloh) Sdn Bhd
 NO.5 & 7, Block D, Jalan Gelen J, U19/J,
 Megamas Business Centre, Kg Baru Sg. Buloh,
 47000 Sg. Buloh, Selangor Darul Ehsan, Malaysia
 Tel: 03-6148 1198 (Hunting Line)
 Fax: 03-6148 2811
 Email: sbnb@standardbolts.net

SBN Johor (Branch)

Standard Bolts & Nuts Supply Sdn Bhd
 No. 12 & 14, Jalan Ros Merah 2/17,
 Taman Johor Jaya,
 81100 Johor Bahru, Johor.
 Tel: 07-358 3221 (Hunting Line)
 Fax: 07-364 9279
 Email: sbnjb@standardbolts.net



標準螺絲供應有限公司 (513831-P) STANDARD BOLTS & NUTS SDN. BHD.

No. 47 & 49, Jalan TPP 1/1, Taman Industri Puchong, 12th Miles,
47100 Puchong, Selangor Darul Ehsan, Malaysia.

Tel: 03-8062 3811 (Hunting Line)

Fax: 03-8062 2230, 8068 2811

Website: <http://www.standardbolts.net>

E-mail: sale@standardbolts.net



DROP IN ANCHOR

INSTALLATION PERIMETER & LOADING DATA

DROP IN ANCHOR ZINC GALVANISED										
Anchor Size	Hole Diameter	Minimum Hole Depth	Minimum Concrete Thickness	Tightening Torque (Nm)	Recommended Spacing & Edge Distance To Full Loads		Absolute Minimum Spacing & Edge Distance		Recommended Load (kN)	
					Tension	Shear	Tension	Shear	Tension ¹⁾	Shear ²⁾
M6 (1/4")	8MM	30MM	60MM	5	75MM	38MM	25MM	25MM	2.5	3.4
M8 (5/16")	10MM	35MM	70MM	10	90MM	45MM	30MM	30MM	3.4	6.3
M10 (3/8")	12MM	45MM	80MM	20	120MM	60MM	40MM	40MM	5.1	9.9
M12 (1/2")	16MM	55MM	100MM	40	150MM	75MM	50MM	50MM	7.1	14.5
M16 (5/8")	20MM	70MM	130MM	95	195MM	98MM	65MM	65MM	15.0	26.9
M20 (3/4")	25MM	90MM	160MM	175	240MM	120MM	80MM	80MM	17.4	42.0

1) Loading based on standard embedment depth and non-cracked concrete, $f_{ck,cube} = 25 \text{ N/mm}^2$ (C20/25)
2) Shear load based on carbon steel class 5.8. Loading will be increased if higher carbon steel grade is used.

DROP IN ANCHOR STAINLESS STEEL 304 (A2) AND STAINLESS STEEL 316 (A4)										
Anchor Size	Hole Diameter	Minimum Hole Depth	Minimum Concrete Thickness	Tightening Torque (Nm)	Recommended Spacing & Edge Distance To Full Loads		Absolute Minimum Spacing & Edge Distance		Recommended Load (kN)	
					Tension	Shear	Tension	Shear	Tension ¹⁾	Shear ²⁾
M6 (1/4")	8MM	30MM	60MM	5	75MM	38MM	25MM	25MM	2.5	3.9
M8 (5/16")	10MM	35MM	70MM	10	90MM	45MM	30MM	30MM	3.4	7.0
M10 (3/8")	12MM	45MM	80MM	20	120MM	60MM	40MM	40MM	5.1	11.2
M12 (1/2")	16MM	55MM	100MM	40	150MM	75MM	50MM	50MM	7.1	16.2
M16 (5/8")	20MM	70MM	130MM	95	195MM	98MM	65MM	65MM	15.0	30.2
M20 (3/4")	25MM	90MM	160MM	175	240MM	120MM	80MM	80MM	17.4	47.1

1) Loading based on standard embedment depth and non-cracked concrete, $f_{ck,cube} = 25 \text{ N/mm}^2$ (C20/25)
2) Shear load based on stainless steel 304 or 316.

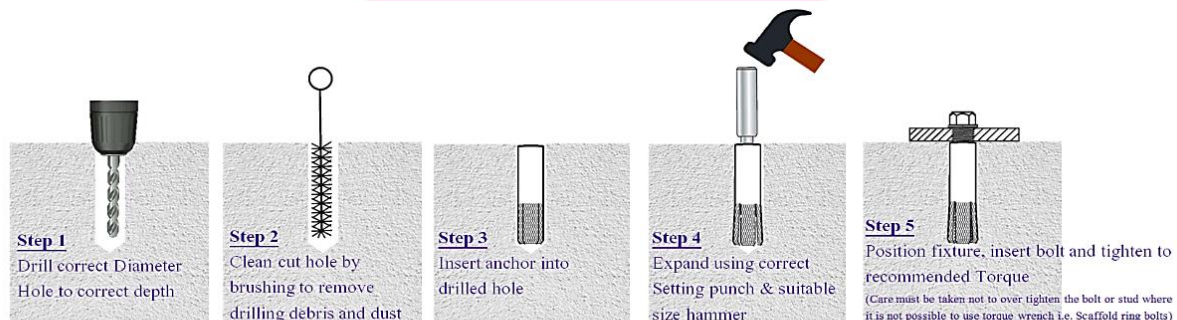

INSTALLATION STEPS FOR DROP IN ANCHOR

SBN Klang (Branch)

Standard Bolts & Nuts (Klang) Sdn Bhd
No. 135 & 137, Jalan Batu Tiga Lama,
Berkeley Town center, 41300 Klang,
Selangor Darul Ehsan, Malaysia
Tel: 03-3344 1198 (Hunting Line)
Fax: 03-3344 2811
Email: sbnk@standardbolts.net

SBN Sg Buloh (Branch)

Standard Bolts & Nuts (Sg. Buloh) Sdn Bhd
NO.5 & 7, Block D, Jalan Gelen J, U19/J,
Megamas Business Centre, Kg Baru Sg. Buloh,
47000 Sg. Buloh, Selangor Darul Ehsan, Malaysia
Tel: 03-6148 1198 (Hunting Line)
Fax: 03-6148 2811
Email: sbnbs@standardbolts.net

SBN Johor (Branch)

Standard Bolts & Nuts Supply Sdn Bhd
No. 12 & 14, Jalan Ros Merah 2/17,
Taman Johor Jaya,
81100 Johor Bahru, Johor.
Tel: 07-358 3221 (Hunting Line)
Fax: 07-364 9279
Email: sbnjb@standardbolts.net